

Part Number	Thread	A	B	C
R20-5-MS	1/4-20	5 mm	0.438"	1.378"
R20-10-SC	1/4-20	10 mm	0.63"	1.75"
R20-15-SC	1/4-20	15 mm	0.875"	1.75"
R20-20-SC	1/4-20	20 mm	1.125"	1.75"
R20-30-SC	1/4-20	30 mm	1.6"	2.5"
R20-50-SC	1/4-20	50 mm	2.5"	2.5"
R8-10-SC	M8	10 mm	16 mm	44.5 mm
R8-15-SC	M8	15 mm	22.2 mm	44.5 mm
R8-20-SC	M8	20 mm	28.6 mm	44.5 mm
R8-30-SC	M8	30 mm	41.7 mm	63.5 mm
R8-50-SC	M8	50 mm	64 mm	63.5 mm
R6-5-SC	M6	5 mm	11.3 mm	35 mm
R6-10-SC	M6	10 mm	16 mm	44.5 mm
R6-15-SC	M6	15 mm	22.2 mm	44.5 mm
R6-20-SC	M6	20 mm	28.6 mm	44.5 mm
R6-30-SC	M6	30 mm	41.7 mm	63.5 mm
R6-50-SC	M6	50 mm	64 mm	63.5 mm
R4-5-SC	M4	5 mm	11.3 mm	35 mm
R4-10-SC	M4	10 mm	16 mm	44.5 mm
R4-15-SC	M4	15 mm	22.2 mm	44.5 mm
R4-20-SC	M4	20 mm	28.6 mm	44.5 mm

Suction Cups with Housing

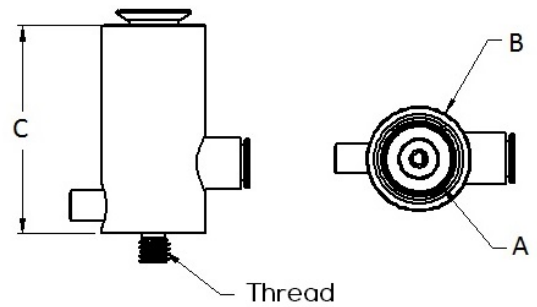

Part Number	Thread	A	B	C	Inc. Angle
R20-5-VSC	1/4-20	5 mm	0.438"	1.46"	90°
R20-10-VSC	1/4-20	10 mm	0.75"	1.875"	120°
R20-15-VSC	1/4-20	15 mm	1"	1.95"	120°
R20-20-VSC	1/4-20	20 mm	1.25"	2"	120°
R20-30-VSC	1/4-20	30 mm	1.75"	2.75"	120°
R20-50-VSC	1/4-20	50 mm	1.75"	3"	120°
R8-10-VSC	M8	10 mm	19 mm	50.8 mm	120°
R8-20-VSC	M8	20 mm	31.8 mm	50.8 mm	120°
R8-30-VSC	M8	30 mm	44.5 mm	75 mm	120°
R8-50-VSC	M8	50 mm	44.5 mm	75 mm	120°
R6-5-VSC	M6	5 mm	11 mm	37 mm	90°
R6-10-VSC	M6	10 mm	19 mm	37 mm	120°
R6-15-VSC	M6	15 mm	23.8 mm	50.8 mm	120°
R6-20-VSC	M6	20 mm	31.8 mm	50.8 mm	120°
R6-30-VSC	M6	30 mm	44.5 mm	75 mm	120°
R6-50-VSC	M6	50 mm	44.5 mm	75 mm	120°
R4-5-VSC	M4	5 mm	11 mm	37 mm	90°
R4-10-VSC	M4	10 mm	19 mm	50.8 mm	120°
R4-15-VSC	M4	15 mm	23.8 mm	50.8 mm	120°
R4-20-VSC	M4	20 mm	31.8 mm	50.8 mm	120°

V-Suction Cups with Housing

